

SERIES 700001 STAINLESS STEEL BALL VALVE

2 pc stainless steel ASTM A351 - CF8M ball valve.

- Full port sizes 1/8" to 4".
- Pressure rating 2000 PSI WOG - 150 PSI steam.
- Temperature to 366°F.
- Blow out proof stem, adjustable stem packing.
- P.T.F.E. seats, packing, and thrust washer.
- 4 bolt actuator mounting pad.

100% electronically tested in the open and closed position at 80 PSI
TUV T.A.Luft approved.

AVAILABLE FIRE SAFE APPROVED WITH ANTISTATIC STEM AND
P.T.F.E.+CARBON SEATS

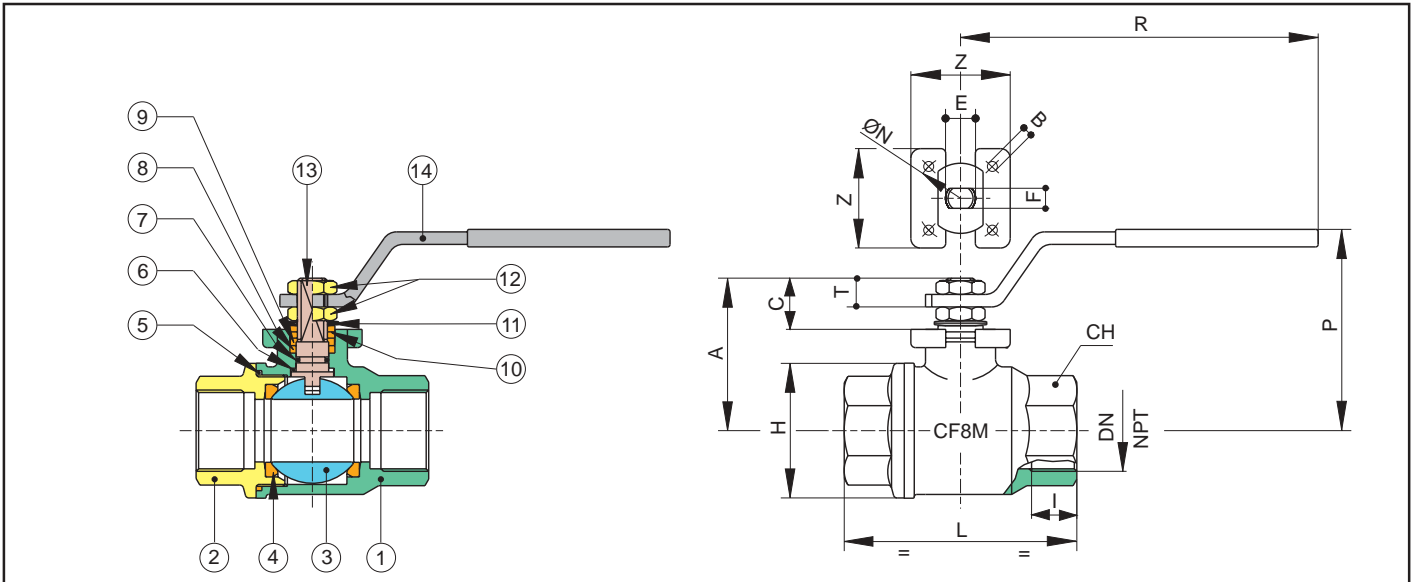

N Pos	PART NAME	MATERIALS	N PCS
1	BODY	CF8M	1
2	END CONNECTION	CF8M	1
3	BALL	AISI 316 - CF8M	1
4	BALL SEAT	P.T.F.E.	2
5	SEAT	P.T.F.E.	1
6	THRUST WASHER	P.T.F.E.	1
7	O-RING	FKM (Viton®)	1
8	STEM SEAL	P.T.F.E.	1
9	PACKING GLAND	AISI 303 (1/8" - 2") STEEL (2 1/2" - 4")	1
10	END STOP	AISI 430 (1/8" - 2") STEEL (2 1/2" - 4")	2
11	SPRING WASHER	STEEL (2 1/2" - 4")	2
12	NUT	AISI 304 (1/8" - 2") STEEL (2 1/2" - 4")	2
13	STEM	AISI 316	1
14	HANDLE	AISI 430 (1/8" - 2") STEEL (2 1/2" - 4")	1

SIZE	I	L	H	CH	R	P	A	C	T	E	F	N	B	Z	CV	PSI	Lbs
1/8"	in 0.29	2.18	1.18	0.86	4.35	1.96	1.37	0.53	0.35	0.31	0.19	-	-	-	5.80	2000	0.59
1/4"	in 0.43	2.18	1.18	0.86	4.35	1.96	1.37	0.53	0.35	0.31	0.19	1.41	0.21	1.41	6.30	2000	0.57
3/8"	in 0.44	2.18	1.18	0.86	4.35	1.96	1.37	0.53	0.35	0.31	0.19	1.41	0.21	1.41	7.00	2000	0.52
1/2"	in 0.59	2.59	1.41	1.06	4.35	2.08	1.49	0.53	0.35	0.31	0.19	1.41	0.21	1.41	19.00	2000	0.70
3/4"	in 0.64	3.11	1.77	1.25	5.17	2.67	2.00	0.59	0.39	0.39	0.27	1.65	0.21	1.65	34.50	2000	1.19
1"	in 0.75	3.66	2.12	1.61	6.88	3.11	2.36	0.76	0.49	0.47	0.31	1.65	0.21	1.65	52.00	2000	2.18
1 1/4"	in 0.84	3.93	2.51	1.96	6.88	3.28	2.53	0.76	0.49	0.47	0.31	1.65	0.21	1.65	103.90	2000	2.95
1 1/2"	in 0.84	4.33	3.14	2.16	9.84	3.93	3.11	0.94	0.64	0.62	0.39	1.96	0.25	1.96	268.40	2000	4.71
2"	in 1.01	5.15	3.74	2.75	9.84	4.21	3.38	0.94	0.64	0.62	0.39	1.96	0.25	1.96	309.30	2000	7.40
2 1/2"	in 1.18	6.25	4.80	3.54	12.65	5.00	4.09	1.12	0.72	0.78	0.55	2.75	0.26	2.51	630.20	2000	14.10
3"	in 1.31	7.28	5.66	4.13	12.65	5.41	4.48	1.10	0.70	0.78	0.55	2.75	0.26	2.51	1018.80	2000	22.04
4"	in 1.54	8.74	6.96	5.11	15.01	6.16	5.39	1.35	0.86	0.94	0.70	4.01	0.33	3.62	1622.10	2000	39.90