

SERIES 760005 STAINLESS STEEL BALL VALVE

Split Body, stainless steel ASTM A351 - CF8M, flanged ANSI 150 ball valve.

- Full port sizes 1/2" to 8"
- Blow out proof stem, adjustable stem packing.
- P.T.F.E. seats, packing and thrust washer.
- Standard grounded stem and ball.

- 100% tested
- PED 97/23/CE
- Standard locking device.

Flange ANSI B16.5, length ANSI B16.10. - Fire Safe approved API 6FA - BS 6755/2 - ISO 10497, TUV T.A. Luft approved - Antistatic BS 5146 - ISO 7121.

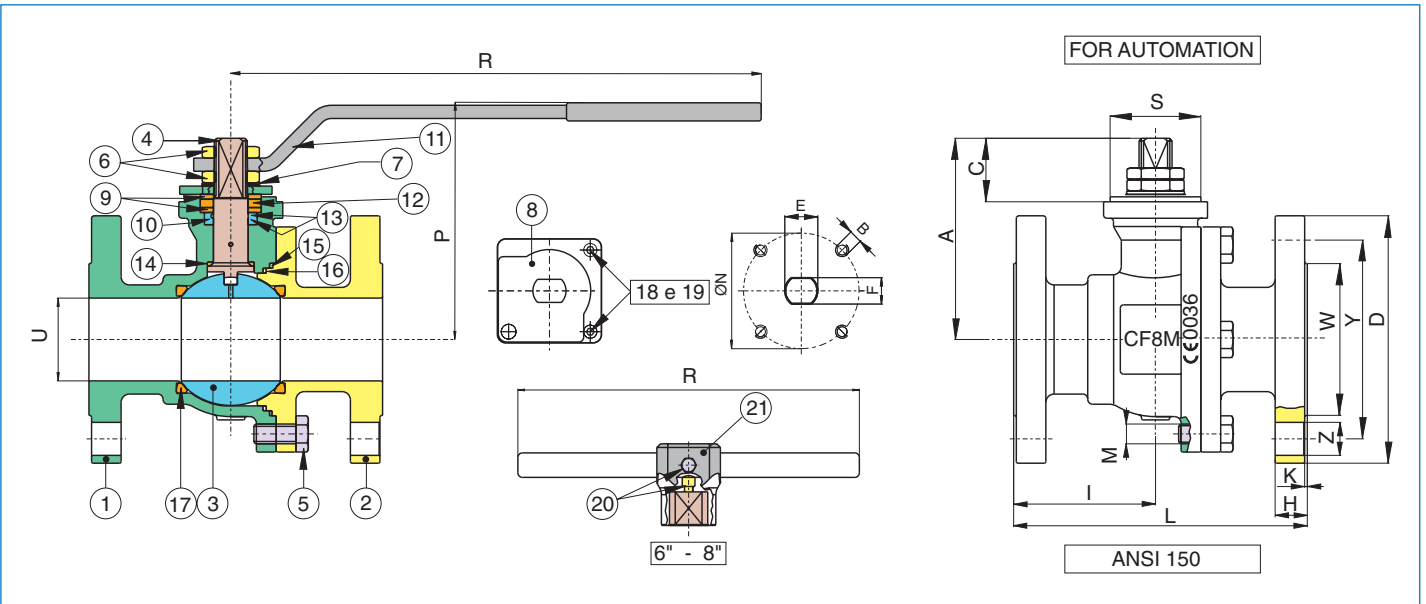

N Pos	PART NAME	MATERIAL	N Pos	SIZE	U	D	Y	Z	I	L	M	P	R	A	C	W	H	K	E	F	ØN	B	S	CV	Lbs
1	BODY	A351 CF8M	1	1/2"	0.59	3.50	2.38	Ø0.62x4	1.83	4.25	M10X4	2.72	5.20	2.00	0.72	1.38	0.45	0.06	M10	0.28	Ø1.65 (F04)	M5	1.18	19.02	4.21
2	END CONNECTION	A351 CF8M	1																						
3	BALL	AISI 316 (1/2" - 1 1/2") STEEL (2" - 8")	1	3/4"	0.75	3.88	2.75	Ø0.62x4	2.09	4.62	M10X4	2.80	5.20	2.07	0.72	1.69	0.51	0.06	M10	0.28	Ø1.65 (F04)	M5	1.18	34.43	5.35
4	STEM	AISI 316	1																						
5	SCREW	STAINLESS STEEL 1/2" - 2" 3" - 8"	4	1"	0.98	4.25	3.12	Ø0.62x4	2.34	5.00	M10X4	3.54	6.89	2.76	0.98	2.00	0.57	0.06	M12	0.31	Ø1.97 (F05)	M6	1.38	50.18	8.15
6	NUT	STAINLESS STEEL 1/2" - 4" 3/8" - 8"	2																						
7	SPRING WASHER	STEEL	2	1 1/2"	1.50	5.00	3.88	Ø0.62x4	3.03	6.50	M12X4	5.20	9.88	4.20	1.21	2.88	0.69	0.06	M16	0.39	Ø1.97 (F05)	M6	1.38	268.40	15.65
8	TRAVEL STOP	AISI 316	1																						
9	PACKING GLAND	AISI 316	2	2"	1.97	6.00	4.75	Ø0.74x4	3.39	7.00	M12X4	5.67	12.68	4.80	1.52	3.62	0.77	0.06	M20	0.55	Ø2.76 (F07)	M8	2.17	309.20	23.81
10	STEM SEAT	P.T.F.E.	1																						
11	HANDLE	AISI 316	1	3"	2.99	7.50	6.00	Ø0.74x4	3.13	8.00	M12X8	6.77	15.04	5.96	1.68	5.00	0.94	0.06	M24	0.71	Ø4.02 (F10)	M10	2.76	1018.70	47.62
12	STEM SEAT	GRAPHOIL	1																						
13	O-RING	FKM (Viton®)	2	4"	3.94	9.00	7.50	Ø0.74x4	4.33	9.00	M12X8	7.32	15.04	6.50	1.68	6.19	0.94	0.06	M24	0.71	Ø4.02 (F10)	M10	2.76	1622.00	67.02
14	THRUST WASHER	P.T.F.E.	1																						
15	SEAT	GRAPHOIL	1	5"	4.92	10.00	8.50	Ø0.86x4	5.90	14.00	M12x8	8.18	15.04	7.36	1.68	7.31	0.94	0.06	M24	0.71	Ø4.02 (F10)	M10	2.76	1992.00	67.02
16	SEAT	P.T.F.E.	1																						
17	BALL SEATS	P.T.F.E.	2	6"	5.91	11.00	9.50	Ø0.86x4	7.13	15.50	M16X8	11.34	27.56	9.65	2.68	8.50	1.00	0.06	M42	1.18	Ø4.92 (F12)	M12	3.35	2362.00	174.30
18	SCREW	STAINLESS STEEL	2																						
19	GROWER	AISI 304	2	8"	7.87	13.50	11.75	Ø0.86x4	8.35	18.00	M20X8	13.07	27.56	11.36	2.68	10.62	1.14	0.06	M42	1.18	Ø4.92 (F12)	M12	3.35	3174.00	254.60
20	SCREW	STAINLESS STEEL	2																						
21	BODY HANDLE	CAST IRON	1																						

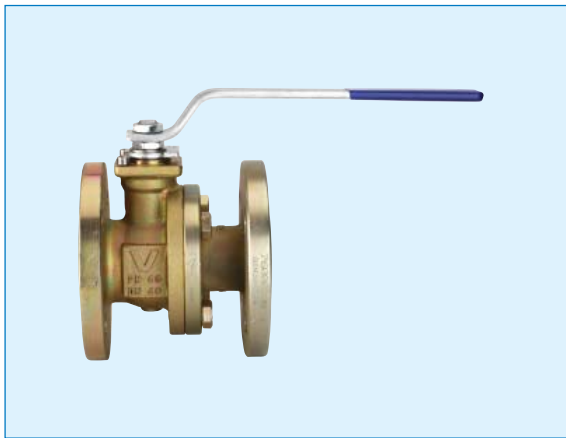

SERIES 762000 CARBON STEEL BALL VALVE

Split Body, carbon steel A216 WCB, flanged ANSI 150 ball valve
 Full port sizes 1/2" to 8".
 Blow out proof stem, adjustable stem packing.
 P.T.F.E. seats, packing and thrust washer.
 • Standard grounded stem and ball.

100% tested.
 PED 97/23/CE.
 • Standard locking device.

Flange ANSI B16.5, length ANSI B16.10 - Fire Safe approved API 6FA - BS 6755/2
 - ISO 10497, TUV T.A. Luft approved - Antistatic BS 5146 - ISO 7121

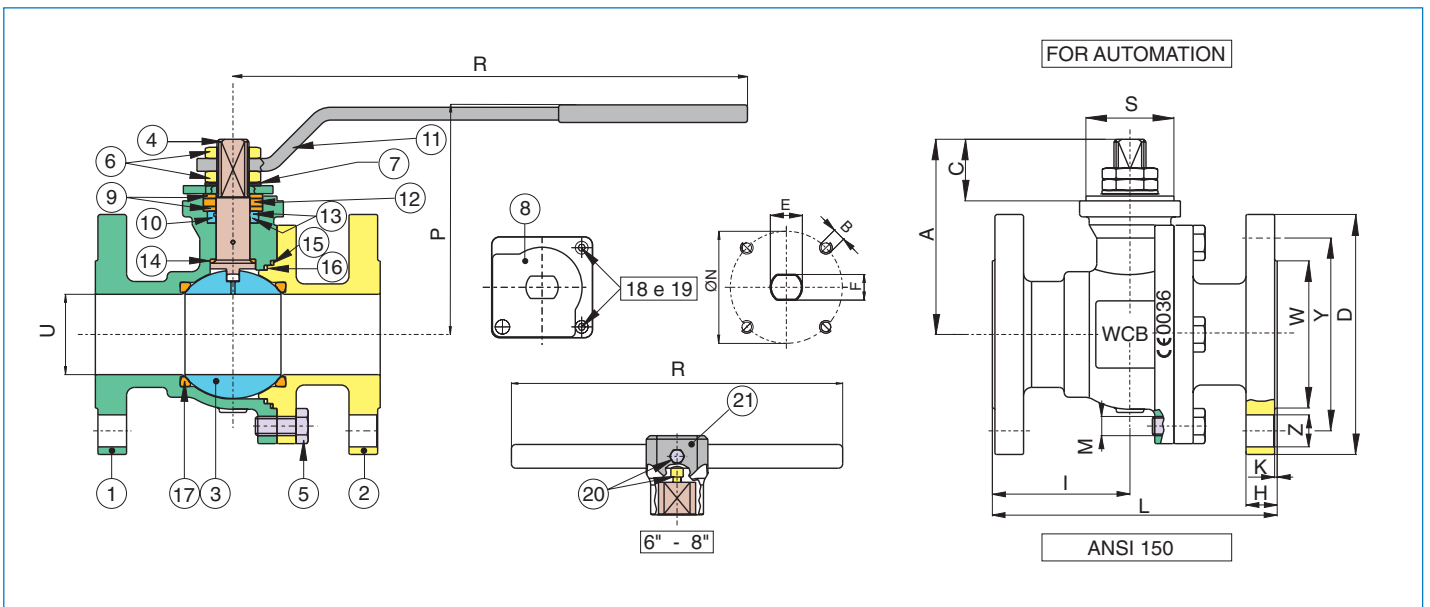

N Pos	PART NAME	MATERIAL	N PCS	SIZE	U	D	Y	Z	I	L	M	P	R	A	C	W	H	K	E	F	ØN	B	S	CV	Lbs
1	BODY	A216 WCB	1	1/2"	0.59	3.50	2.38	Ø0.62x4	1.83	4.25	M10X4	2.72	5.20	2.00	0.72	1.38	0.45	0.06	M10	0.28	Ø1.65 (F04)	M5	1.18	19.02	4.21
2	END CONNECTION	A216 WCB	1																						
3	BALL	AISI 316 (1/2" - 1 1/2") AISI CF8M (2" - 8")	1	3/4"	0.75	3.88	2.75	Ø0.62x4	2.09	4.62	M10X4	2.80	5.20	2.07	0.72	1.69	0.51	0.06	M10	0.28	Ø1.65 (F04)	M5	1.18	34.43	5.35
4	STEM	AISI 316	1																						
5	SCREW	STEEL	4	1"	0.98	4.25	3.12	Ø0.62x4	2.34	5.00	M10X4	3.54	6.89	2.76	0.98	2.00	0.57	0.06	M12	0.31	Ø1.97 (F05)	M6	1.38	50.18	8.15
6	NUT	STEEL	2																						
7	SPRING WASHER	STEEL	2	1 1/2"	1.50	5.00	3.88	Ø0.62x4	3.03	6.50	M12X4	5.20	9.88	4.20	1.21	2.88	0.69	0.06	M16	0.39	Ø1.97 (F05)	M6	1.38	268.40	15.65
8	TRAVEL STOP	STEEL	1																						
9	PACKING GLAND	STEEL	2	2"	1.97	6.00	4.75	Ø0.74x4	3.39	7.00	M12X4	5.67	12.68	4.80	1.52	3.62	0.77	0.06	M20	0.55	Ø2.76 (F07)	M8	2.17	309.20	23.81
10	STEM SEAT	P.T.F.E.	1																						
11	HANDLE	STEEL	1	3"	2.99	7.50	6.00	Ø0.74x4	3.13	8.00	M12X8	6.77	15.04	5.96	1.68	5.00	0.94	0.06	M24	0.71	Ø4.02 (F10)	M10	2.76	1018.70	47.62
12	STEM SEAT	GRAPHOIL	1																						
13	O-RING	FKM (Viton®)	2	4"	3.94	9.00	7.50	Ø0.74x4	4.33	9.00	M12X8	7.32	15.04	6.50	1.68	6.19	0.94	0.06	M24	0.71	Ø4.02 (F10)	M10	2.76	1622.00	67.02
14	THRUST WASHER	P.T.F.E.	1																						
15	SEAT	GRAPHOIL	1	6"	5.91	11.00	9.50	Ø0.86x4	7.13	15.50	M16X8	11.34	27.56	9.65	2.68	8.50	1.00	0.06	M42	1.18	Ø4.92 (F12)	M12	3.35	2362.00	174.30
16	SEAT	P.T.F.E.	1																						
17	BALL SEATS	P.T.F.E.	2	8"	7.87	13.50	11.75	Ø0.86x4	8.35	18.00	M20X8	13.07	27.56	11.36	2.68	10.62	1.14	0.06	M42	1.18	Ø4.92 (F12)	M12	3.35	3174.00	254.60
18	SCREW	STEEL	2																						
19	GROWER	AISI 304	2																						
20	SCREW	STEEL	2																						
21	BODY HANDLE	CAST IRON	1																						

