

Job Name :

Contractor :

Job Location :

Approval :

Engineer :

Contractor's P.O.:

Approval :

Representative :



Series ME700

Grooved End Butterfly-Direct Mount

Features

- Ductile Iron Body-Epoxy Coated
- ISO 5211 Pad & ISO Square Stem
- Makes Electric and Pneumatic actuation simple
- 200Psi Working Pressure
- EPDM Coated Ductile Iron Disc
- Face to Face MSS SP-67
- Meets ANSI/AWWA C606

Options:

L700B = BUNA-N Coated Disc

Specifications

A Grooved End Ductile Iron Butterfly Valve with a rubber coated ductile iron disc. The Valve shall have an epoxy coated body, an ISO 5211 mounting pad, and ISO square stem. In addition the valve should be designed to meet ANSI/AWWA C606 and MSS SP-67.

L700 Cv Chart

Size	Flow in GPM @ 1Psi P @ Various Disc Angles								
	10°	20°	30°	40°	50°	60°	70°	80°	Full 90° Open
2"	0.1	5	12	24	45	64	90	125	135
2-1/2"	0.2	8	20	37	65	98	144	204	220
3"	0.3	12	22	39	70	116	183	275	302
4"	0.5	17	36	78	139	230	364	546	600
5"	0.8	29	61	133	237	392	620	930	1022
6"	2	45	95	205	366	605	958	1437	1579
8"	3	89	188	408	727	1202	1903	2854	3136
10"	4	151	320	694	1237	2047	3240	4859	5340
12"	5	234	495	1072	1911	3162	5005	7505	8250

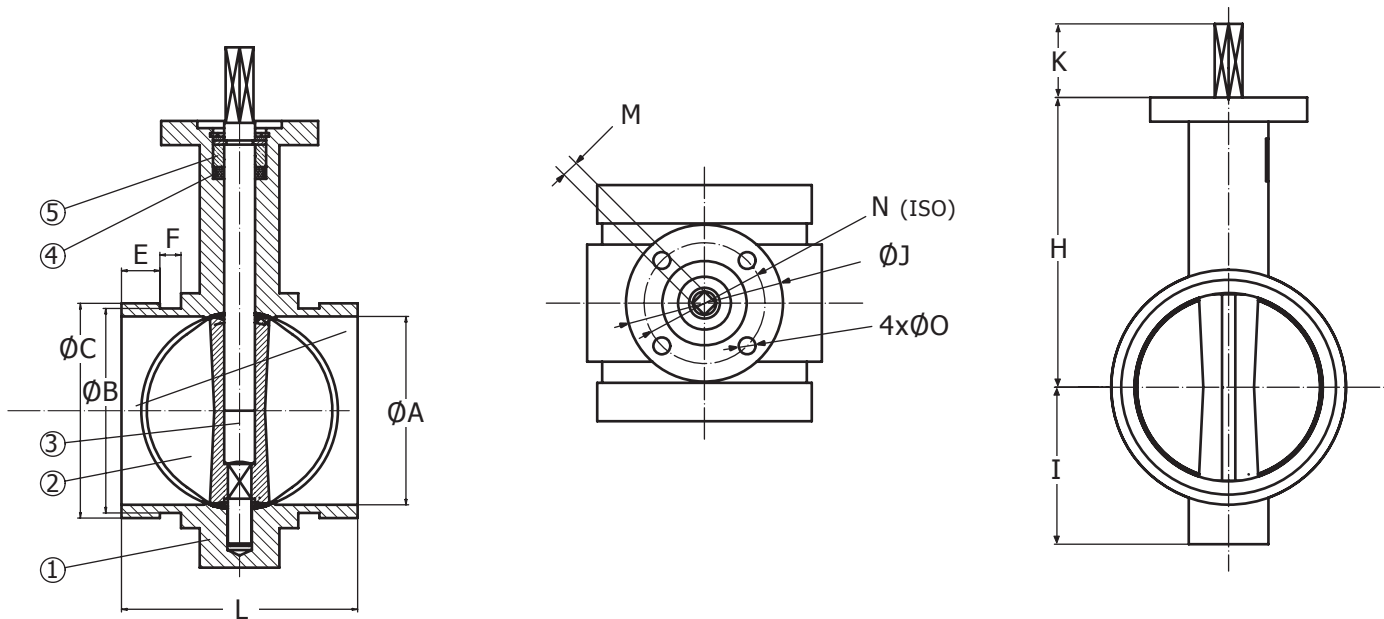

Bill of Materials

No.	Part Name	Material	Pcs.
1	Body	Ductile Iron-ASTM A536 Gr 65-45-12	1
2	Disc	Ductile Iron + NBR/EPDM	1
3	Stem	410 Stainless Steel	1
4	X-Ring	NBR	1
5	Bushing	PTFE	1

Dimensions Series L700E

Size	ØA	ØB	ØC	E	F	H	I	J	K	L	M mm	N	ØO	ISO 5211	Break Torque	Wt/ Lbs
2"	1.96	2.25	2.37	0.62	0.31	4.68	2.48	3.03	1.25	3.24	9	1.96	0.27	F05	124 in/Lbs	3.9
2-1/2"	2.40	2.72	2.87	0.62	0.31	4.94	2.69	3.03	1.25	3.81	9	1.96	0.27	F05	204 in/Lbs	4.8
3"	3.14	3.34	3.50	0.62	0.31	5.17	3.15	3.03	1.25	3.81	9	1.96	0.27	F05	425 in/Lbs	5.9
4"	3.97	4.33	4.50	0.62	0.29	5.94	3.70	3.54	1.25	4.55	11	2.75	0.35	F07	496 in/Lbs	9.9
5"	5.00	5.39	4.50	0.62	0.29	6.75	4.25	3.54	1.25	5.81	14	2.75	0.35	F07	775 in/Lbs	16.7
6"	5.90	6.45	6.62	0.62	0.29	7.20	4.84	3.54	1.25	5.81	14	2.75	0.35	F07	1213 in/Lbs	21.1
8"	7.95	8.44	8.62	0.74	0.43	8.08	5.88	4.92	1.77	5.25	17	4.01	0.47	F10	2434 in/Lbs	32.4
10"	9.96	10.5	10.7	0.74	0.49	9.84	7.32	4.92	1.77	6.25	22	4.01	0.47	F10	4205 in/Lbs	54.4
12"	11.9	12.5	12.7	0.74	0.49	10.8	8.38	4.92	1.77	6.50	22	4.01	0.47	F10	5532 in/Lbs	76.0

Mfg: Bonomi North America, Inc.
 704-412-9031 Charlotte, NC
www.bonominorthamerica.com

Rep: S&K Automation, LLC
 763-476-1013 Plymouth, MN
www.sk-automation.com